

# COMPLETION PACKER ASSEMBLIES

## MODEL TS THERMAL RING SEAL

The Chancellor Model TS Ring Seal Packer is used in steam injection applications. It was developed specifically as an alternative to the conventional thermal packer with expansion joint. The TS Ring Seal packer design is simple, efficient, and very economic. The design is based on metal to metal press contact with the casing I.D.

The dual split seal rings are machined from a mild steel and heat treated to a spring rate. The gap in the rings allow for radial movement and are out of phase from the other. The rings act similar to piston rings as they pass freely through casing collars. By design, the TS Ring Seal Packer will move freely with the expansion and contraction as required of thermal systems. The packer runs in the hole with a slight drag and can pass at a minimum casing drift I.D. There are no slips or elements to set. The seal rings are self energizing. Field tests indicate a high efficiency when compared to exotic high temperature elastomeric packers and cup tools.

The ring seal packers are generally run in sets of two to isolate the intended zones. They have a life of the completion service rating but can be redressed if necessary. A high temperature cup packer can be run in combination with the ring seal packer if pressure integrity is required for isolation.

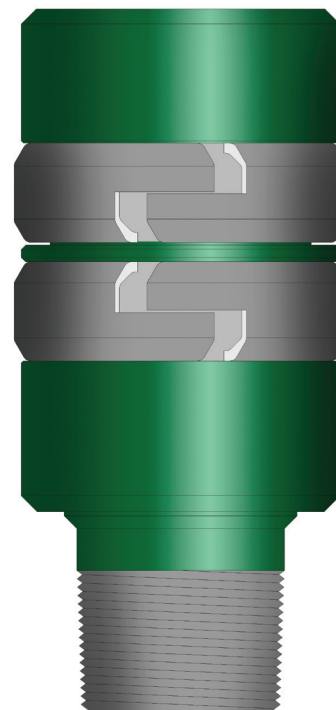

**MODEL TS THERMAL RING SEAL**

SIZE Inches (mm)	WEIGHT lb/ft	TUBING SIZE Inches	MAX O.D. Inches (Rings Relaxed)	MIN O.D. Inches (Rings Compressed)	MIN I.D. Inches	PRODUCT NUMBER
3.500 (88.00)	9.2 - 9.3	1 1/2" EUE	3.040	2.800	1.610	M03127013515
4.500 (114.30)	11.6 - 13.5	2 3/8" NU	4.080	3.768	1.995	M03127014524
5.000 (127.00)	15.0 - 18.0	2 3/8" EUE	4.490	4.125	1.995	M03127015124
5.000 (127.00)	15.0	2 3/8" EUE	4.490	4.250	1.995	M03127015224
5.000 (127.00)	18.0	2 3/8" EUE	4.355	4.125	1.995	M03127015324
5.500 (139.70)	15.5	2 3/8" EUE	5.030	4.625	1.995	M031270155124
5.500 (139.70)	17.0	2 7/8" EUE	4.970	4.750	2.441	M031270155228
5.500 (139.70)	17.0 - 20.0	2 3/8" EUE	4.950	4.625	1.995	M031270155324
5.500 (139.70)	17.0 - 20.0	2 7/8" EUE	4.950	4.625	2.441	M031270155328
7.000 (177.80)	23.0 - 26.0	2 7/8" EUE	6.450	6.125	2.441	M03127017128
7.000 (177.80)	23.0 - 26.0	3 1/2" EUE	6.450	6.125	2.992	M03127017135
7.000 (177.80)	26.0	3 1/2" EUE	6.338	6.125	2.992	M03127017335
7.000 (177.80)	29.0 - 32.0	2 7/8" EUE	6.268	5.950	2.992	M03127017228
7.000 (177.80)	29.0 - 32.0	3 1/2" EUE	6.268	5.950	2.992	M03127017235
9.625 (244.50)	36.0 - 40.0	3 1/2" EUE	9.012	8.688	2.992	M03127019135
9.625 (244.50)	43.5 - 47.0	3 1/2" EUE	8.824	8.500	2.992	M03127019235
9.625 (244.50)	36.0 - 40.0	4 1/2" EUE	9.012	8.688	3.958	M03127019145
9.625 (244.50)	43.5 - 47.0	4 1/2" EUE	8.824	8.500	3.958	M03127019245